

# 5 WAYS TO INCORPORATE SECURITY EARLY IN THE DESIGN PROCESS

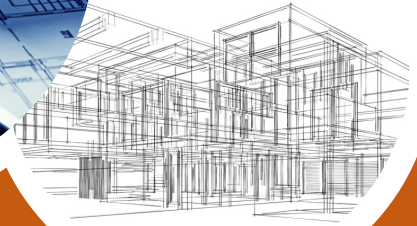

Whether a construction project is a new build, restack or renovation, it is important that security design is incorporated into the plans as early as possible. Doing so will ensure a timely and successful project.

Here are five recommendations to enhance design of security elements in the overall space plan:

1

## **Focus on ensuring a positive user experience**

Assess how security and architecture design will impact the user journey and movement across the space

2

## **Engage with security as a partner**

Collaborate and educate to seamlessly incorporate both form and function into a holistic design

3

## **Make security an integrated part of the design**

Ensure an end result that is in keeping with both the functional requirements and aesthetic vision

4

## **Design with the entirety of the risk portfolio in mind**

Consider security beyond field devices to reduce operational risk and enhance user experience

5

## **Understand the necessity to broaden the perception of security**

Identify amplified risks such as awareness, active or insider threats, perimeter protection

Atriade is a security consulting firm. We provide security system design services for access control, perimeter protection, video and visitor management, and other physical security technologies. We also provide security master planning, program development, risk assessments, project management, and professional services

Our client portfolio includes Fortune 50 companies, Ivy League universities, and leading technology firms in Silicon Valley.

Visit us online at [Atriade.com](https://www.atriade.com)

Connect with us on [LinkedIn](#)

Subscribe to our LinkedIn Newsletter:  
[Take A Risk](#)

